

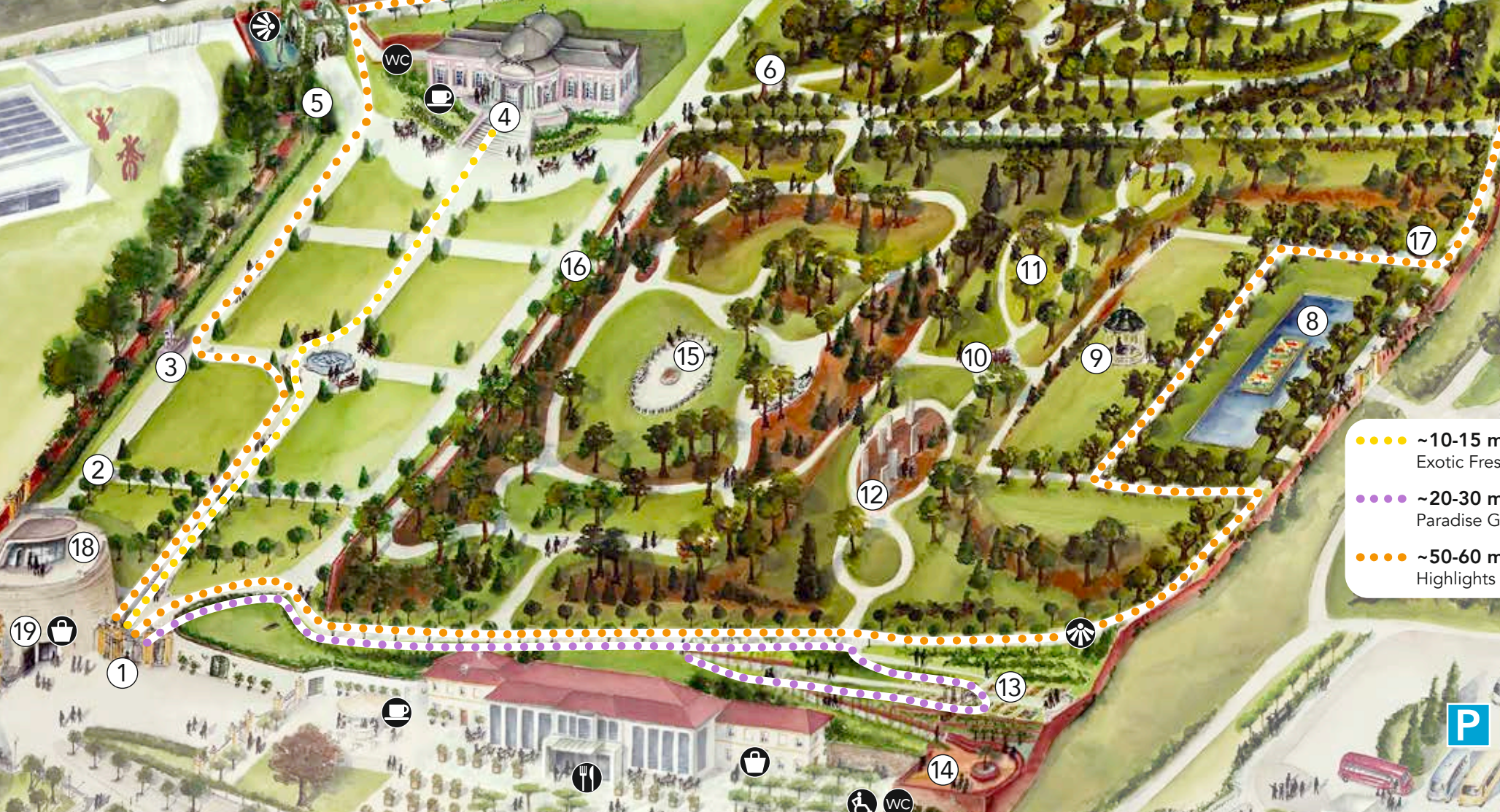

- ~10-15 min  
Exotic Frescoes
- ~20-30 min  
Paradise Garden
- ~50-60 min  
Highlights



## WELCOME IN THE PARK OF MELK ABBEY!

1. Entrance and Exit
2. Baroque Map of the Abbey and the Abbey Park
3. Laurus Edelbacher "The Father, the Son and the Holy Spirit"
4. Baroque Garden Pavilion
5. Cabinet Clairvoyée
6. St. Benedict's Path
7. Jardin Oriental – Asian Wooden Pavilion
8. Baroque Water Reservoir – Christian Philipp Müller "The New World"
9. Neo-Baroque Round Pavilion
10. Miguel Horn "Kissing Monkeys"
11. Gor Chahal "Beyond the Horizon"
12. Hans Hoffer "Talking Stones – The Story of Creation"
13. Paradise Garden – "Walahfrid Strabo Garden"
14. Jardin Méditerranéen
15. Campfire Circle – Miguel Horn "The Fire Devils"
16. Ingrid Kralovec "The Ravens Landed in the Abbey Garden"
17. Commemorative Board – The vanished St. Steven's Church
18. Panoramic Terrace – Northern Bastion, Special Exhibition
19. Shop



### Viewpoints:

Cabinet Clairvoyée: View to the West

Jardin Oriental: View to the East

Jardin Méditerranéen: View to the South

Panoramic Terrace: View over the park, Melk Abbey and the surrounding countryside

